

# ALASKA ECH

## Plug In Bunker

3.2°F ... -7.6°F



Climatic class 3L1  
Humidity 60%  
Ambient temp 77°F  
Air speed 0,2m/sec



Low Temperature Bunker With Sliding Doors

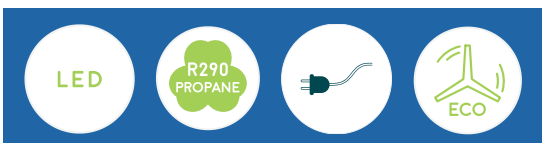

Contact Us

Phone: (347) - 809 3544 Email: [ronald@rimasee.com](mailto:ronald@rimasee.com)

# ALASKA ECH

## Plug In Bunker

3.2°F ... -7.6°F



Climatic class 3L1  
Humidity 60%  
Ambient temp 77°F  
Air speed 0,2m/sec

Introducing the Alaska ECH freezer bunker - the perfect blend of style and efficiency. With stunning front and side displays, this bunker is a must have for any establishment looking to display better, save on energy and maintenance cost. It features a variable speed compressor for optimal performance and energy savings. The interior and exterior are constructed with high quality galvanized sheet metal, coated in PVC to meet food regulations. The entire cold circuit is made of copper, ensuring long lasting durability. The Alaska ECH boasts front and side triple glazing with internal resistance to prevent condensation, a height adjustable false bottom, LED lighting with automatic control, automatic defrosting, water evaporation and a maintenance free condenser.



Low Temperature Bunker With Sliding Doors

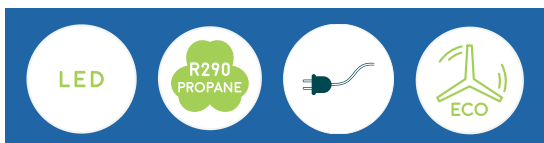

Contact Us

Phone: (347) - 809 3544 Email: [ronald@rimasee.com](mailto:ronald@rimasee.com)

# ALASKA ECH

## Plug In Bunker

3.2°F ... -7.6°F



Climatic class 3L1  
Humidity 60%  
Ambient temp 77°F  
Air speed 0,2m/sec

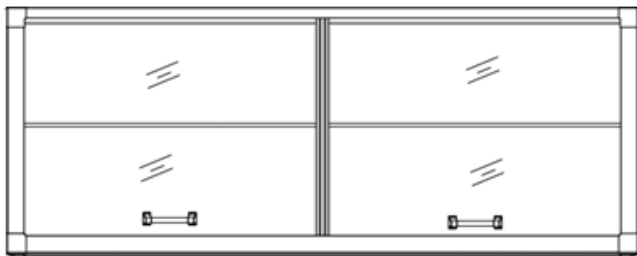
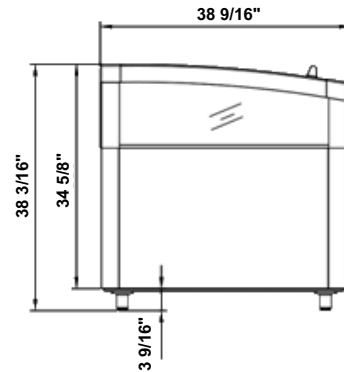
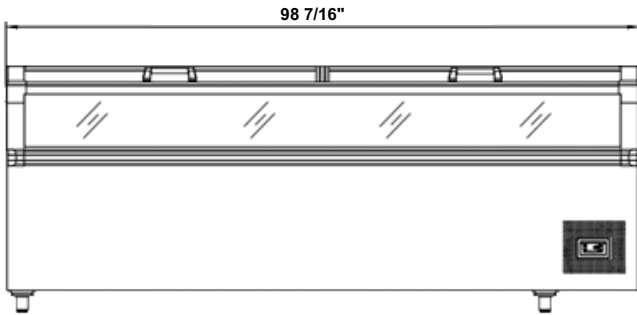
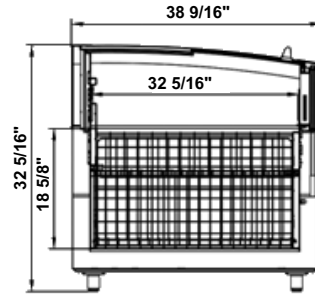
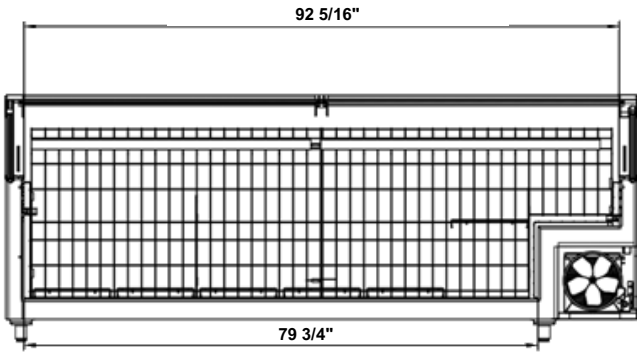

NOTE: We reserve the right to change or revise specifications and product design in connection with any feature of our products. Such changes do not entitle the buyer to corresponding changes, improvements, additions, or replacements for equipment previously sold or shipped.

It is the "model of the future" for low temperature bunkers. For even greater customization , the Alaska ECH can be tailored to your specific needs upon request

Low Temperature Bunker With Sliding Doors

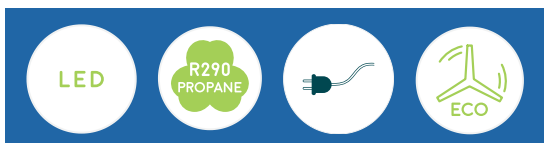

Contact Us

Phone: (347) - 809 3544 Email: ronald@rimasee.com