

# ALASKA ECH TOWER

## Plug In Bunker Tower

3.2°F ... -7.6°F



Climatic class 3L1  
Humidity 60%  
Ambient temp 77°F  
Air speed 0,2m/sec



Low Temperature Bunker Tower

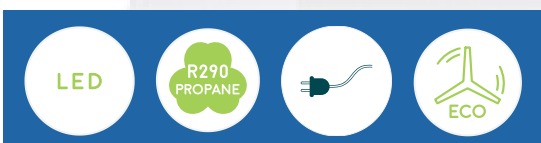

Contact Us  
Phone: (347) - 809 3544 Email: [ronald@rimasee.com](mailto:ronald@rimasee.com)

# ALASKA ECH TOWER



## Plug In Bunker Tower

3.2°F ... -7.6°F

Climatic class 3L1  
Humidity 60%  
Ambient temp 77°F  
Air speed 0,2m/sec

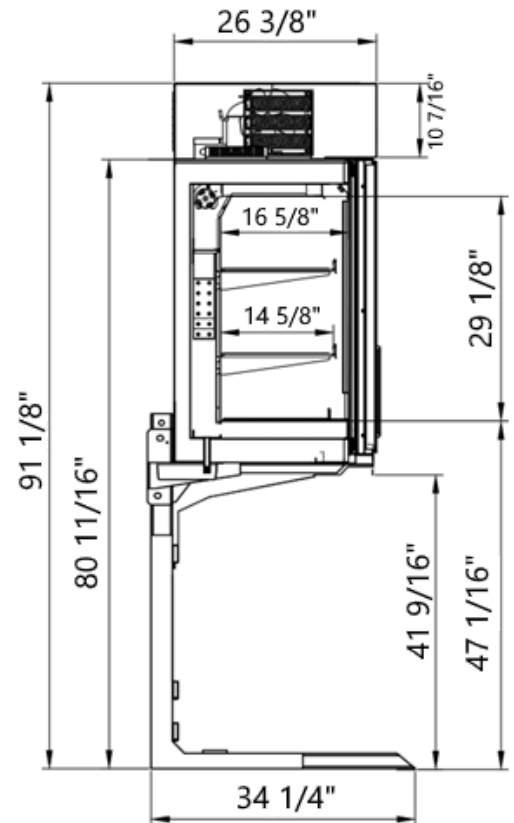
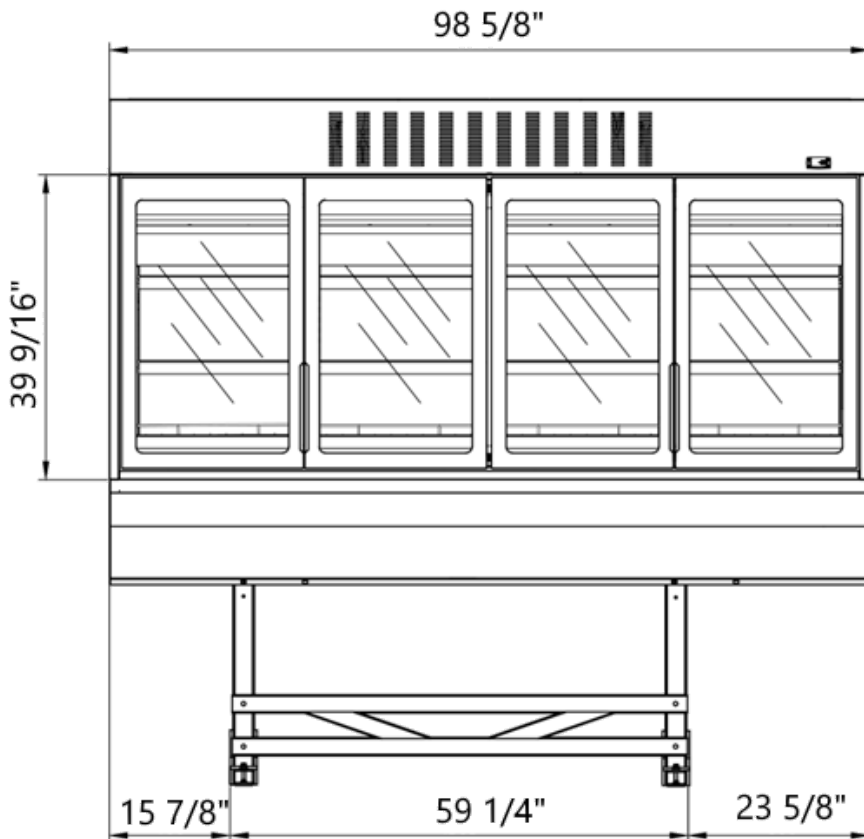

NOTE: We reserve the right to change or revise specifications and product design in connection with any feature of our products. Such changes do not entitle the buyer to corresponding changes, improvements, additions, or replacements for equipment previously sold or shipped.

It is the "model of the future" for low temperature bunkers. For even greater customization, the Alaska ECH Tower can be tailored to your specific needs upon request

Low Temperature Bunker Tower

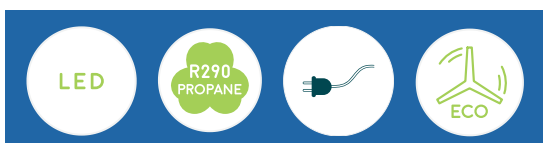

RIMASEE

Contact Us

Phone: (347) - 809 3544 Email: ronald@rimasee.com

# ALASKA ECH TOWER



## Plug In Bunker Tower

3.2°F ... -7.6°F

Climatic class 3L1  
Humidity 60%  
Ambient temp 77°F  
Air speed 0,2m/sec

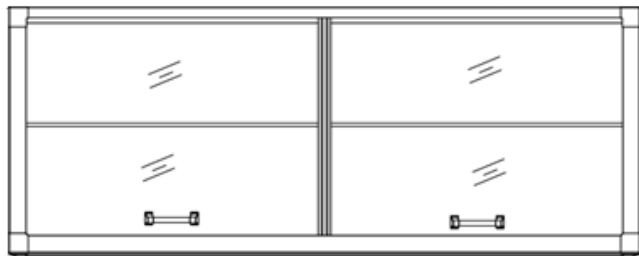
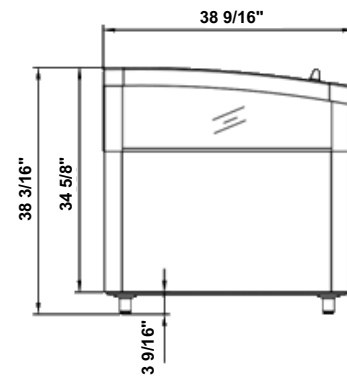
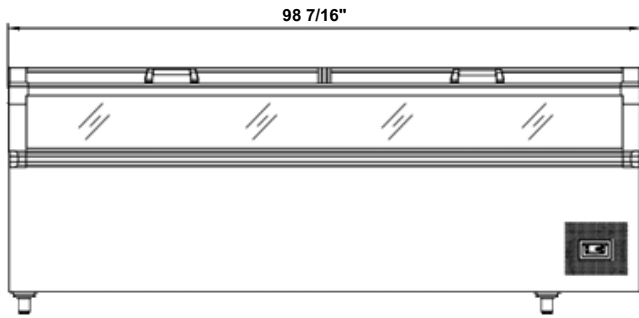
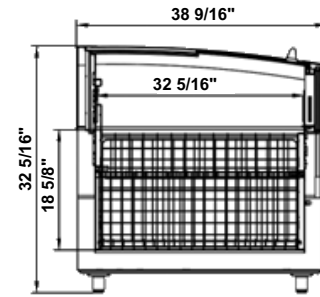
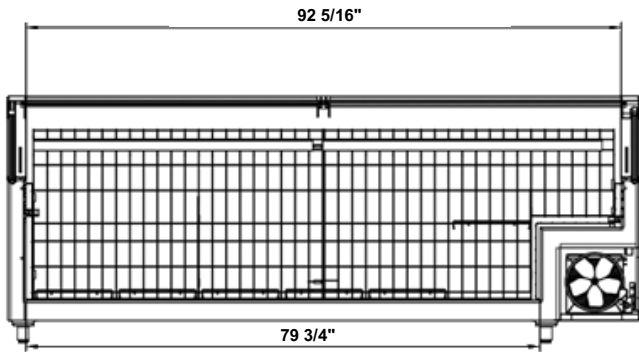

NOTE: We reserve the right to change or revise specifications and product design in connection with any feature of our products. Such changes do not entitle the buyer to corresponding changes, improvements, additions, or replacements for equipment previously sold or shipped.

It is the "model of the future" for low temperature bunkers. For even greater customization, the Alaska ECH can be tailored to your specific needs upon request

Low Temperature Bunker Tower

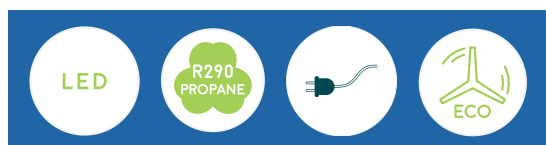

Contact Us

Phone: (347) - 809 3544 Email: ronald@rimasee.com