



**ALASKA PLUG-  
IN SERIES**



RIMASEE



# ALASKA ECH 2500

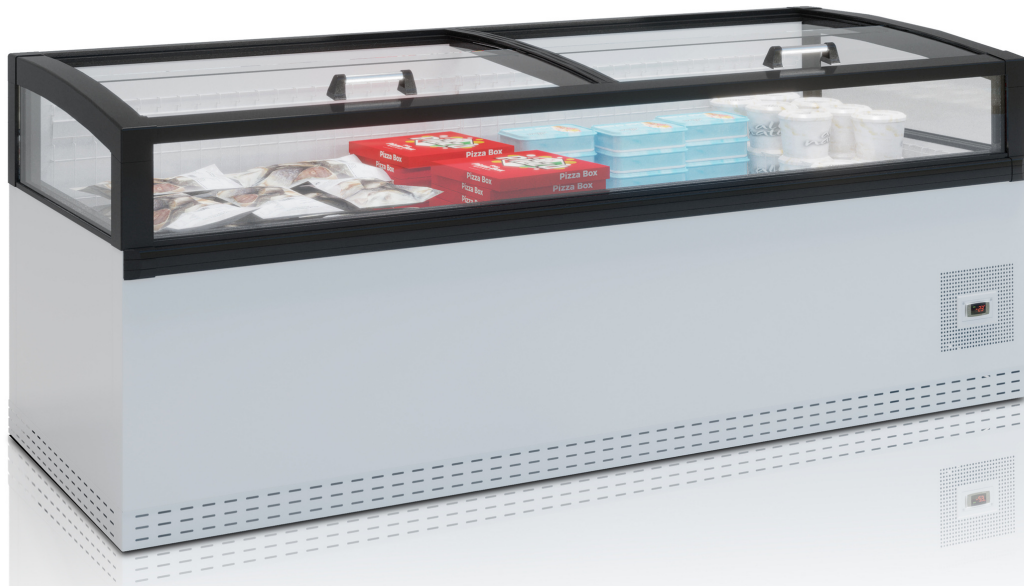

Introducing the Alaska ECH 2500 freezer bunker – the perfect blend of style and efficiency. With stunning front and side displays, this cabinet is a must have for any establishment. It features a variable speed compressor for optimal performance and maximum energy savings. The interior and exterior are constructed with high quality galvanized sheet metal, coated in PVC to meet food regulations. The entire cold circuit is made of copper, ensuring long lasting durability.

The Alaska ECH 2500 boasts front and side triple glazing with internal resistance to prevent condensation, a height adjustable false bottom, LED lighting with automatic control, automatic defrosting, water evaporation, and a maintenance free condenser. It's the model of the future for freezer bunkers.

For given greater customization, the Alaska ECH 2500 can be tailored to your specific needs upon request. Choose from a variety of options to create a personalized display that best showcases our products and brand. Upgrade your establishment with the Alaska ECH 2500 freezer bunker today and experience the perfect blend of design, efficiency and functionality.



# ALASKA ECH 2500

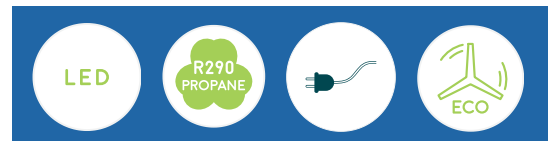
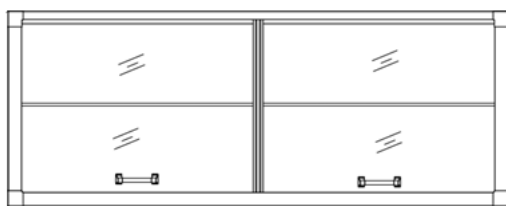
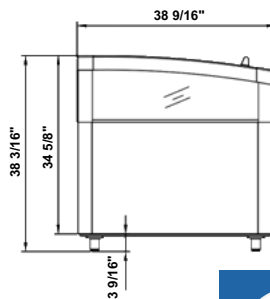
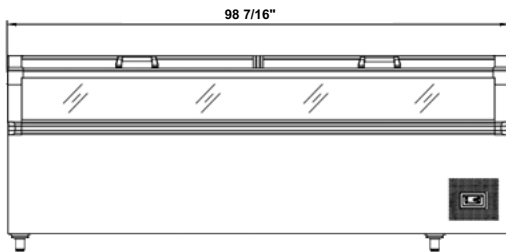
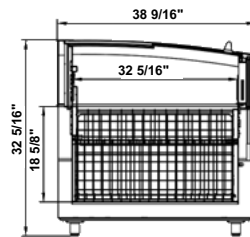
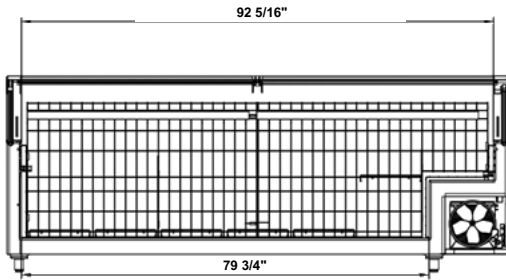

NOTE: We reserve the right to change or revise specifications and product design in connection with any feature of our products. Such changes do not entitle the buyer to corresponding changes, improvements, additions, or replacements for equipment previously sold or shipped.





# ALASKA ECH 2500

		Alaska ECH 2500 DE	Alaska ECH 2500 DEPN
<b>Technical Data</b>			
Total Display Area (TDA)	ft <sup>2</sup>	20.77	20.77
Climatic Class (EN23953)		3L1	3L1 & 3M1
Temperature Range	°F	3/-7.6	-7.6/10
Maintenance free condenser		Yes	Yes
Visual Alarm		Yes	Yes
HACPP - Hazrd analysis and critical control points		Yes	Yes
Surveillance System		Optional	Optional
Net Volume	Qt	867.5	867.5
Gross Volume	Qt	1394.8	1394.8
<b>Electrical Data</b>			
Voltage / Frequency	V/Hz	220-110/60	220-110/60
Rated Power	W	520	520
Rated Current	Amps	2.4	2.4
Energy Consumption	kWh/24h	9.15	9.15(-)/3.8(+)
Energy Efficiency Index (EEI)		34.8	34.8
<b>Refrigerant Data</b>			
Refrigerant Type		R290	R290
Number of Compressors		1	1
Maximum Operating Pressure	bar	30	30
<b>Dimensions and Weight Data</b>			
Cabinet Dimensions	inches	98 7/16" x 38 9/16" x 37 5/8"	98 7/16" x 38 9/16" x 37 5/8"
Packaging Dimensions	inches	102 5/8" x 41 15/16" x 40 1/2"	102 5/8" x 41 15/16" x 40 1/2"
Net Weight	lbs	419	419
Gross Weight	lbs	529	529





# ALASKA DUO 2200

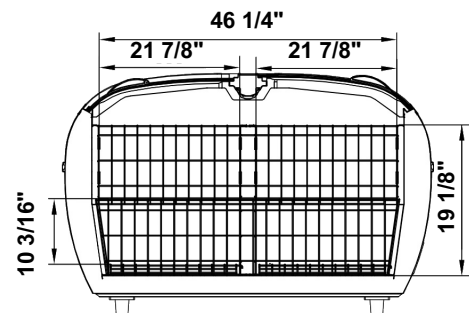
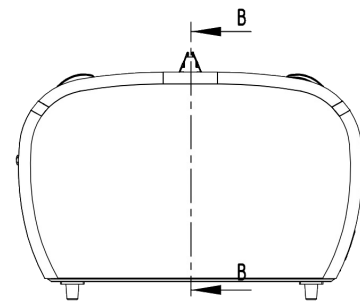
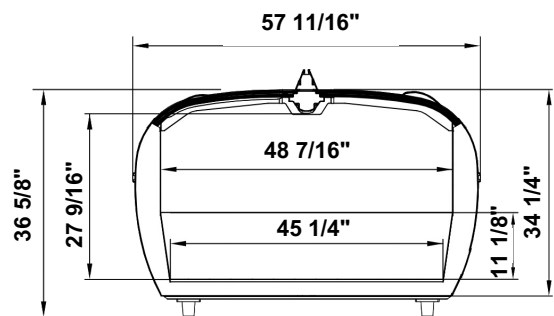
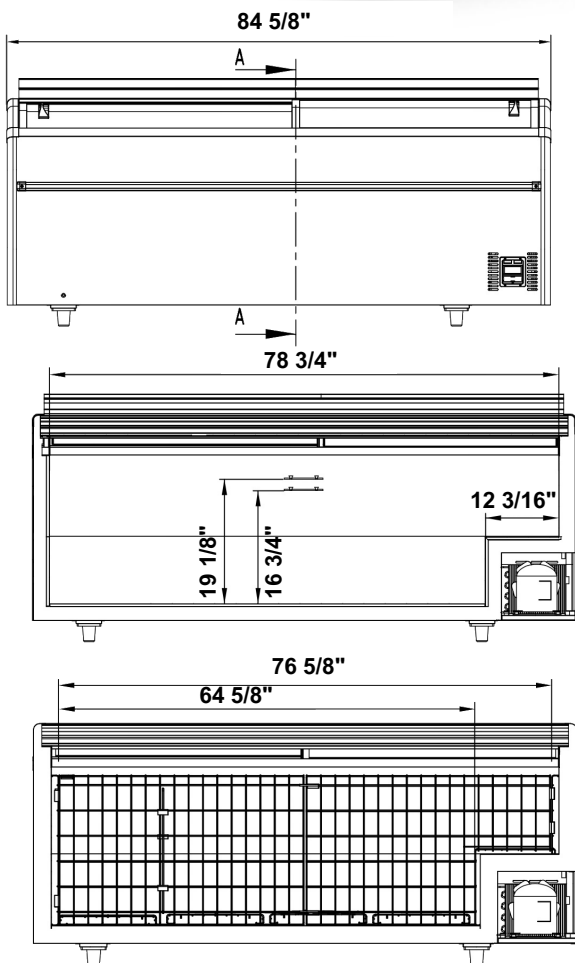

NOTE: We reserve the right to change or revise specifications and product design in connection with any feature of our products. Such changes do not entitle the buyer to corresponding changes, improvements, additions, or replacements for equipment previously sold or shipped.



RIMASEE



# ALASKA DUO 2200

		Alaska DUO 2200 DE	Alaska DUO 2200 DEPN
<b>Technical Data</b>			
Total Display Area (TDA)	ft <sup>2</sup>	29.06	29.06
Climatic Class (EN23953)		3L1	3L1 & 3M1
Temperature Range	°F	3/-7.6	-7.6/10
Maintenance free condenser		Yes	Yes
Visual Alarm		Yes	Yes
HACPP - Hazrd analysis and critical control points		Yes	Yes
Surveillance System		No	No
Net Volume	Qt	1326	1326.5
Gross Volume	Qt	1793.2	1793.2
<b>Electrical Data</b>			
Voltage / Frequency	V/Hz	220-110/60	220-110/60
Rated Power	W	522	716
Rated Current	Amps	2.5	5.8
Energy Consumption	kWh/24h	9.2	9.15(-)/3.8(+)
Energy Efficiency Index (EEI)		24.70	26.70
<b>Refrigerant Data</b>			
Refrigerant Type		R290	R290
Number of Compressors		2	2
Maximum Operating Pressure	bar	30	30
<b>Dimensions and Weight Data</b>			
Cabinet Dimensions	inches	84 5/8" x 57 11/16" x 36 5/8"	84 5/8" x 57 11/16" x 36 5/8"
Packaging Dimensions	inches	88 3/16" x 61 " x 41 5/16"	88 3/16" x 61 " x 41 5/16"
Net Weight	lbs	437	437
Gross Weight	lbs	553.4	553.4

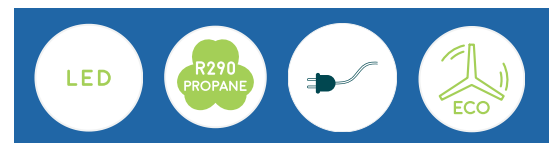



# ALASKA DUO 2200





# ALASKA ECH TOWER

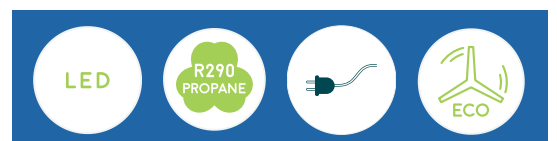



# ALASKA TOWER

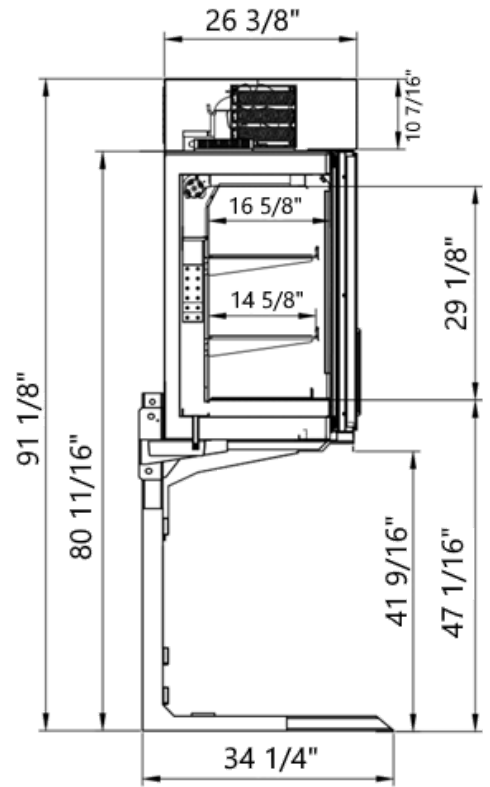
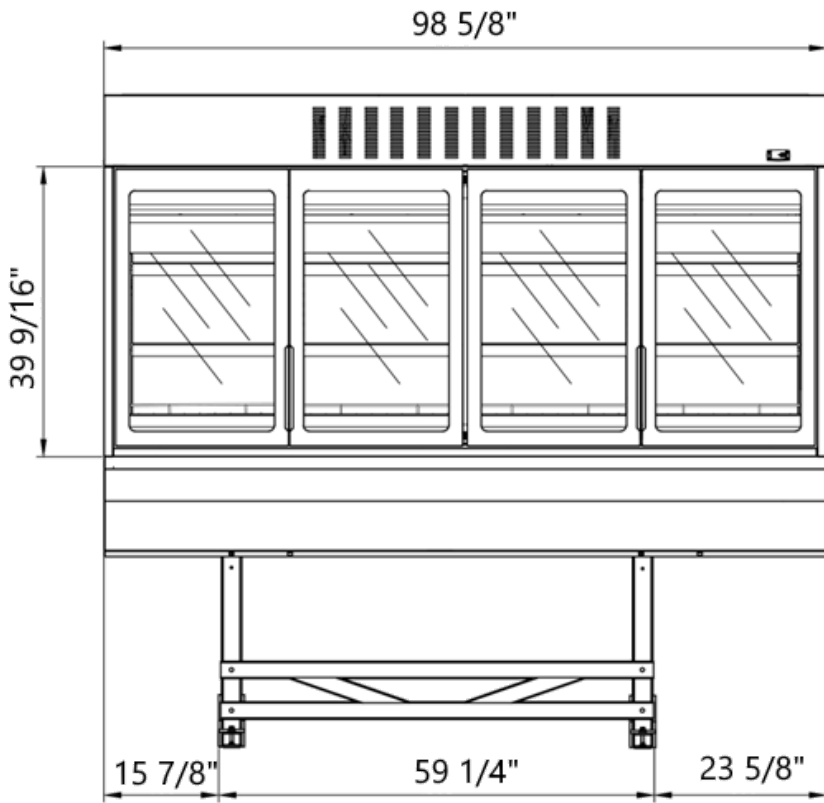

NOTE: We reserve the right to change or revise specifications and product design in connection with any feature of our products. Such changes do not entitle the buyer to corresponding changes, improvements, additions, or replacements for equipment previously sold or shipped.

It is the "model of the future" for low temperature bunkers. For even greater customization, the Alaska ECH Tower can be tailored to your specific needs upon request

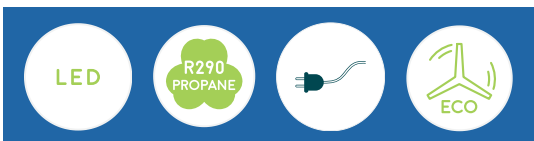



# ALASKA ECH TOWER

		Alaska TOWER	Alaska ECH 2500 DE
<b>Technical Data</b>			
Total Display Area (TDA)	ft <sup>2</sup>	18.3	20.77
Climatic Class (EN23953)		3L1	3L1
Temperature Range	°F	3/-11.2	3/-7.6
Maintenance free condenser		Yes	Yes
Visual Alarm		Yes	Yes
HACPP - Hazrd analysis and critical control points		Yes	Yes
Surveillance System		Optional	Optional
Net Volume	Qt	678	867.5
Gross Volume	Qt	803	1394.8
<b>Electrical Data</b>			
Voltage / Frequency	V/Hz	220-110/60	220-110/60
Rated Power	W	1300	520
Rated Current	Amps	7.5	2.4
Energy Consumption	kWh/24h	15.5	9.15
Energy Efficiency Index (EEI)		34.9	34.8
<b>Refrigerant Data</b>			
Refrigerant Type		R290	R290
Number of Compressors		2	1
Maximum Operating Pressure	bar	30	30
<b>Dimensions and Weight Data</b>			
Cabinet Dimensions	inches	98 7/16" x 57 11/16" x 37 "	98 7/16" x 38 9/16" x 37 5/8"
Packaging Dimensions	inches	104 3/4" x 41 3/4" x 65 3/4"	102 5/8" x 41 15/16" x 40 1/2"
Net Weight	lbs	1019	419
Gross Weight	lbs	1195	529

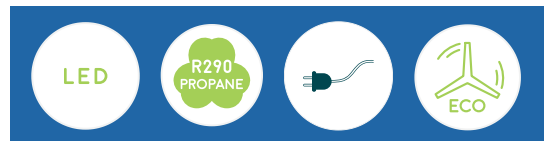





# ALASKA PLUG- IN SERIES

**TALK TO US**

(347) - 809 - 3544

[www.rimasee.com](http://www.rimasee.com)

[sales@rimasee.com](mailto:sales@rimasee.com)



RIMASEE