

# ALASKA 100 SC



## Upright Low Temperature Reach-In Frefreezer

-5.8...-0.4°F  
-21...-18°C

Climatic class 3L1  
Humidity 60%  
Ambient temp +25°C  
Air speed 0,2m/sec



Upright Low Temperature Reach-In Frefreezer



RIMASEE

Contact Us

Phone: (347) - 809 3544 Email: sales@rimasee.com

# ALASKA 100 SC



## Upright Low Temperature Reach-In Frefzer

--5.8....-0.4°F  
-21...-18°C

Climatic class 3L1  
Humidity 60%  
Ambient temp +25°C  
Air speed 0,2m/sec

### Standard

- 4 levels of removable, adjustable, and tiltable shelves
- Self-closing hinged front doors with double tempered glass
- Display area in skinplate
- Exterior decoration in skinplate
- Solid sides
- Ventilated refrigeration
- Vertical LED lighting
- Electronic temperature controller
- Programmable automatic defrosting
- Automatic evaporation of defrost water
- Adjustable feet

### Options

- Display area in painted plate (RAL)
- Display area in AISI 304 stainless steel
- Exterior decoration in painted plate (RAL)
- Exterior decoration in AISI 304 stainless steel
- Treated evaporator
- Castors with brakes



### Complements

- 1 level of removable/adjustable hooks (4 units)
- 1 level of removable/adjustable hooks with price holders (4 units)
- 1 level of skinplate shelves
- 1 level of stainless steel shelves

#### Standard Mounting



Levelling Feet

#### Optional Mounting



Adjustable Legs



Casters



## Upright Low Temperature Reach-In Frefzer



RIMASEE

Contact Us

Phone: (347) - 809 3544 Email: sales@rimasee.com

# ALASKA 100 SC



## Upright Low Temperature Reach-In Frefreezer

-5.8...-0.4°F  
-21...-18°C

Climatic class 3L1  
Humidity 60%  
Ambient temp +25°C  
Air speed 0,2m/sec

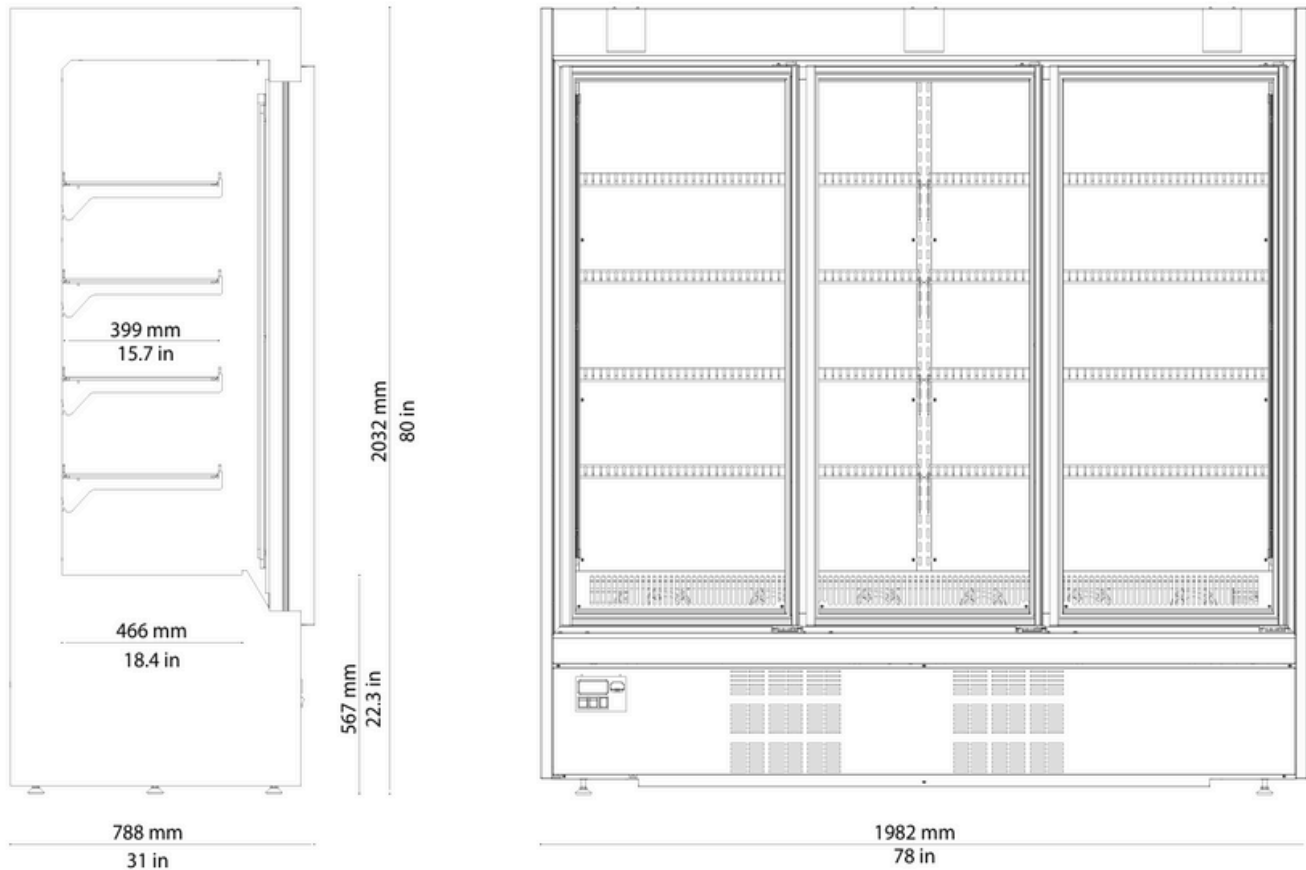

78"x31"x80" / 1982x788x2032 mm

Refrigerated shelf area (m2)	3,77
Insulation	PUR/H2O
Nominal power (W)	2906
Electric current (A)	14,23
Total energy consumption (kWh/24h)	28,700   -
Annual energy consumption (kWh/annum)	10475,50   -
Energy efficiency class*	E

NOTE: We reserve the right to change or revise specifications and product design in connection with any feature of our products. Such changes do not entitle the buyer to corresponding changes, improvements, additions, or replacements for equipment previously sold or shipped.

NOTE These cases are engineered to operate in locations not exceeding 75°F and 55% R.H. These cases are designed to operate using R290 refrigerant. Ventilation grills at front and back cannot be blocked.

### Upright Low Temperature Reach-In Frefreezer



Contact Us

Phone: (347) - 809 3544 Email: sales@rimasee.com

